

Battery of 4WD robot car use precautions:

1. Please use the charger we provide to charge the car.
2. The car cannot be used while charging.
3. The voltage needs to be charged in time at around 9V. When the charging is completed, the battery voltage is about 12.6V.
4. If you do not use the car for a long time, you should unplug the battery cable from the bottom plate of the car. Because even if the car is in standby, the battery will be worn out.
5. If you have not used the car for a long time, you need to fully charge the battery before using it next time, then use the car.
6. When the battery is charging, the charger indicator lights up red, the indicator will turn green after charging is complete. After charging is completed, the charger and power supply should be unplugged in time to avoid overcharging and damaging the battery.

The charging method is as shown below:**The first case:**

If your car is such a battery, please use the first method to charge.

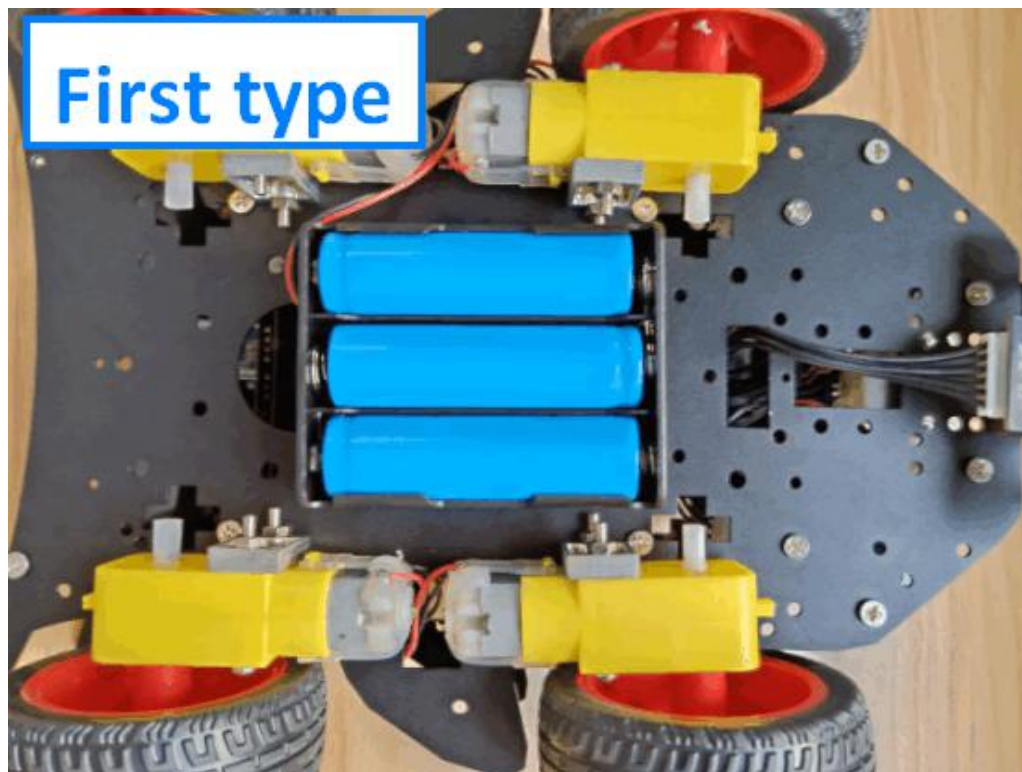

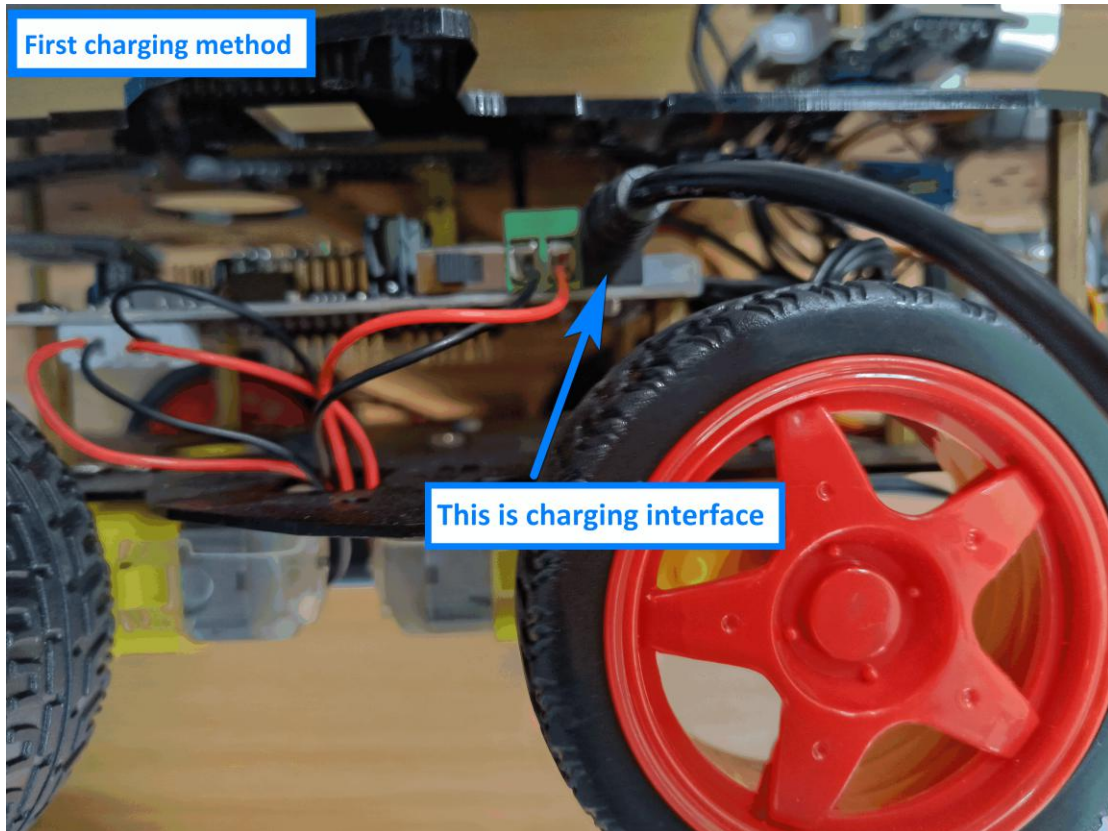

The second case:

If your car is such a battery, please use the second method to charge.

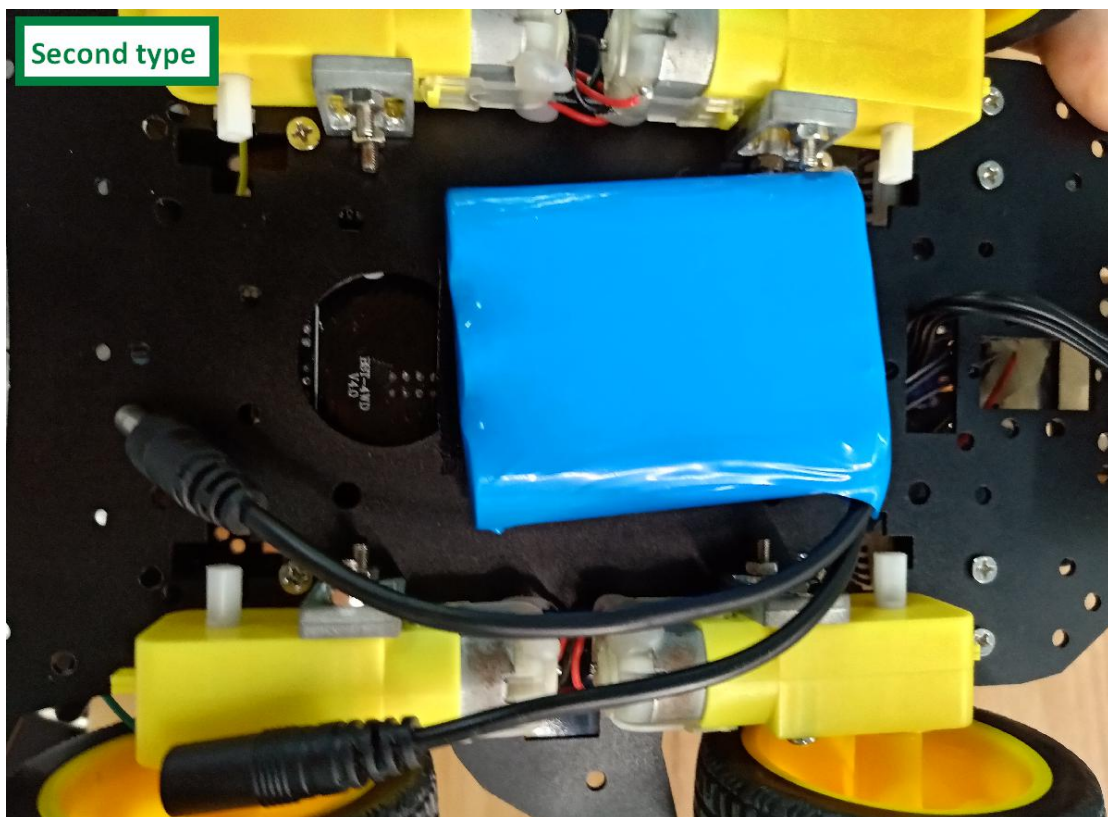

Note: Do not connect the battery's charging port and voltage output port together.

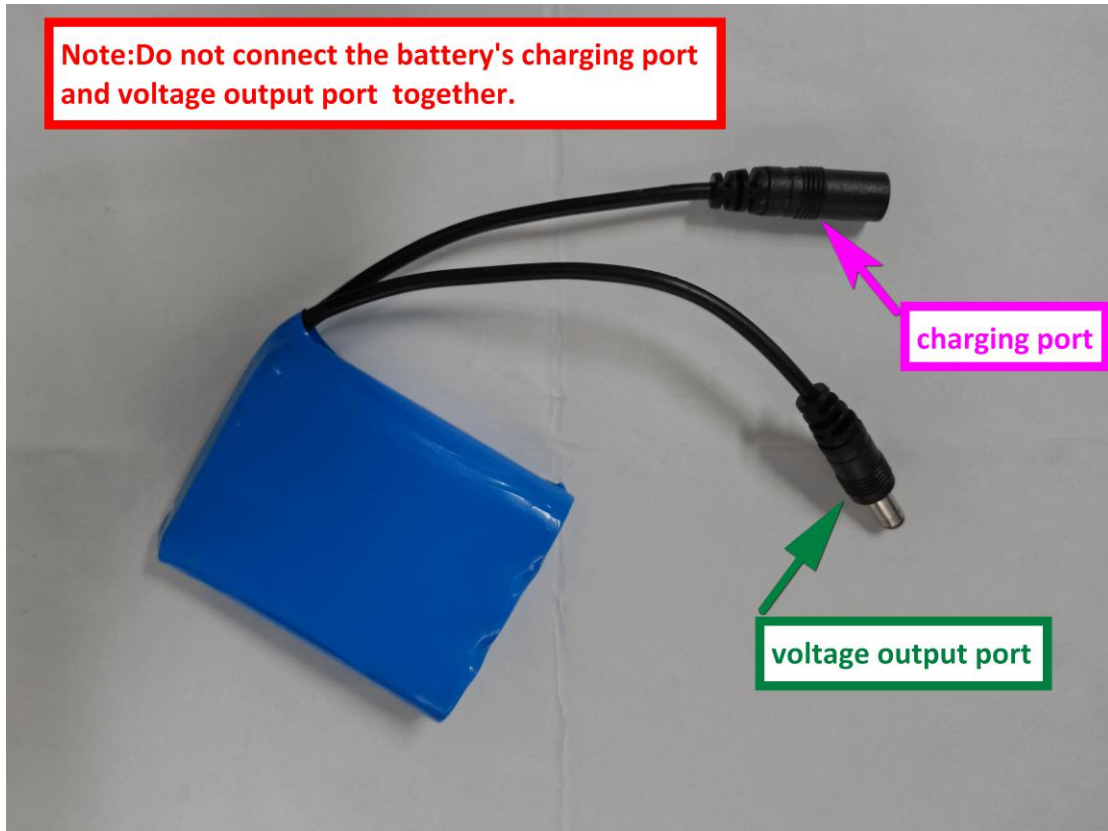

Second charging method

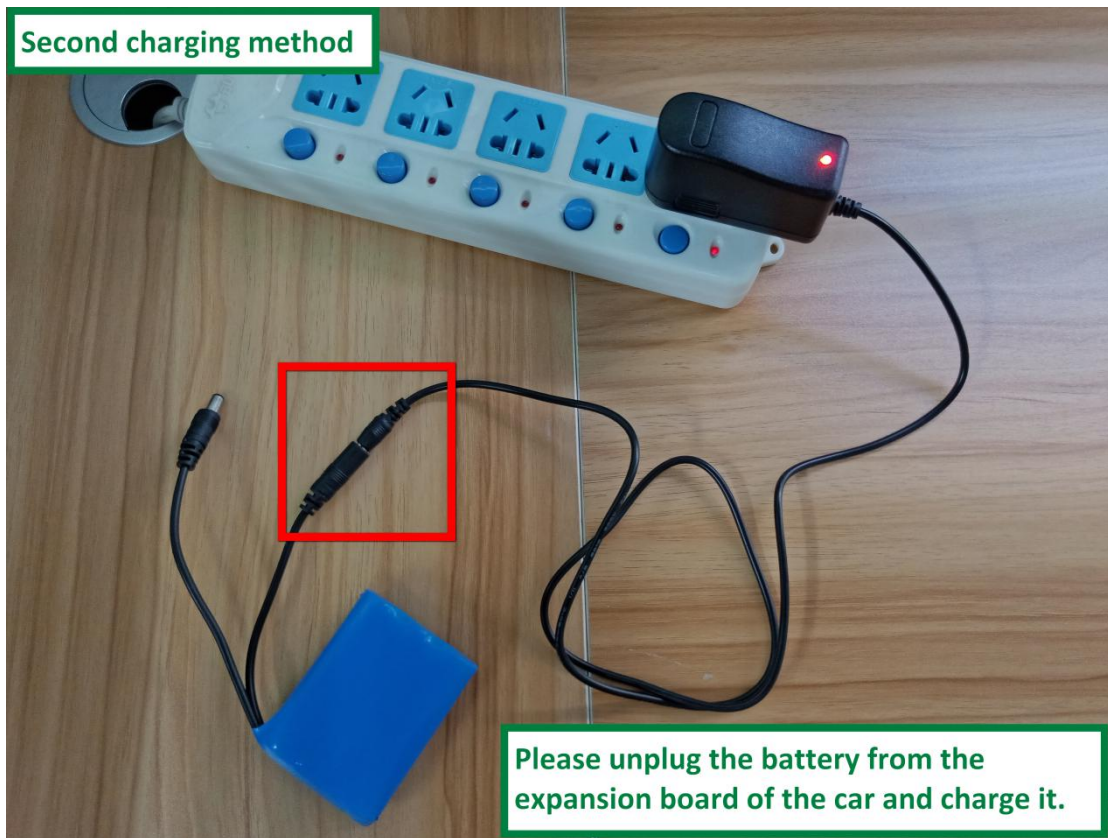

Please unplug the battery from the expansion board of the car and charge it.

