

KFM-200

Fiber Connector Microscope



Product characteristics

- The amplification rates of 200 and 400 times are switched to each other.
- Imported coated lens, stain clearly visible.
- White LED, rated for 100,000 hours; 40 hour battery life
- Grinded silica gel shell, anti-skid, anti-fall and anti-shock.
- Supporting SC/FC/ST/LC
- 1.25 mm & 2.5mm adapter
- Small size, one-handed, convenient and fast.

Supporting SC/FC/ST/LC



USE EFFECT:

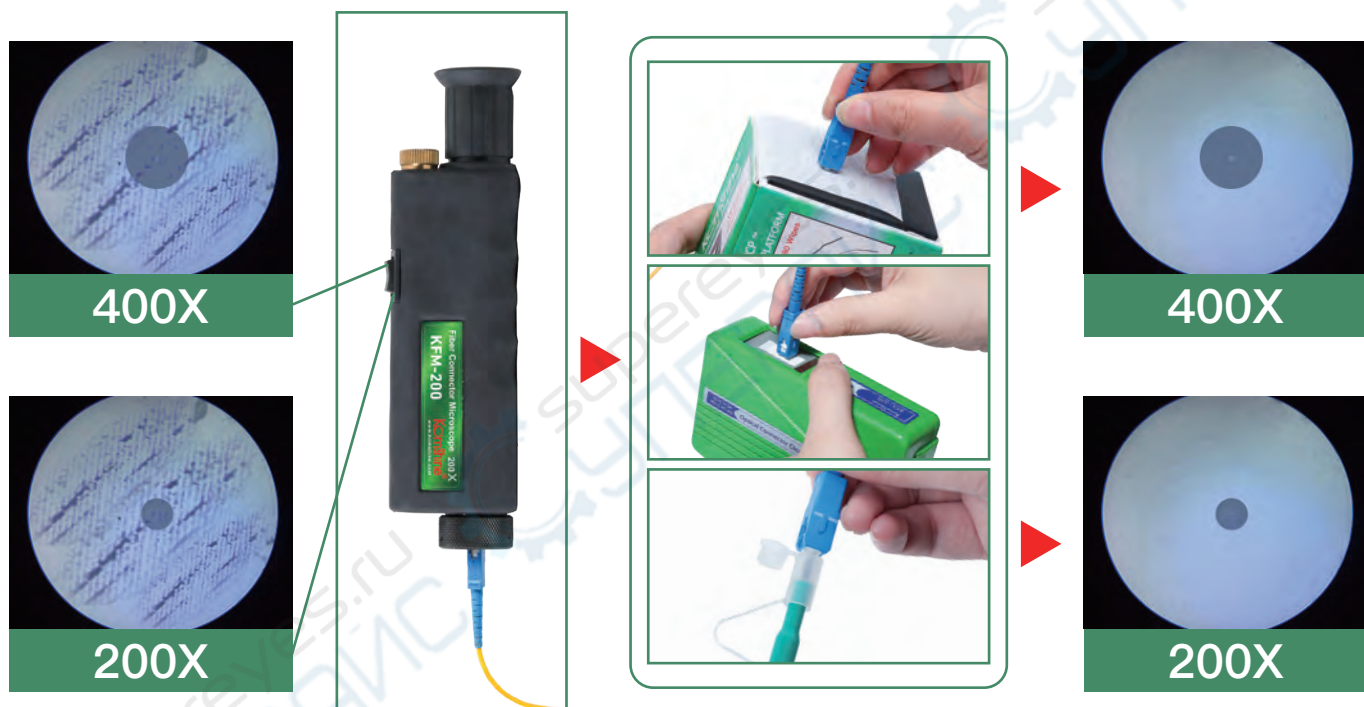

PRODUCT SPECIFICATION:

Magnification	200x & 400x
Light Source	White LED, rated for 100,000 hours; 40 hour battery life
Size	225mm x 60mm x 42mm
Adapter Interface	1.25 mm & 2.5mm universal adapter included
Interface type	SC, FC, ST and LC
Includes	host machine 1.25 mm & 2.5mm adapter Nylon black bag Brand new 3x AAA battery Packing box

PRODUCT LIST:



CONTACT US:

KomShine Technologies Limited

HEAD OFFICE:

2F Building#2 Huashen Technology Park, Yuhua district Nanjing, JS, 210001,
P.R. China

TEL: +86 (025) 66047688

www.komshine.com

ventas@komshine.com

- * Komshine reserves the right to improve, enhance, or modify the features and specifications of KomShine products without prior notification.
- * Company and product names appearing in this catalogue are registered marks or trademarks of respective companies.
- * This catalogue is printed using environmentally friendly paper and ink.