

# CXG<sup>®</sup> 392A MANUAL

## Vacuum suction station

### Product parts list

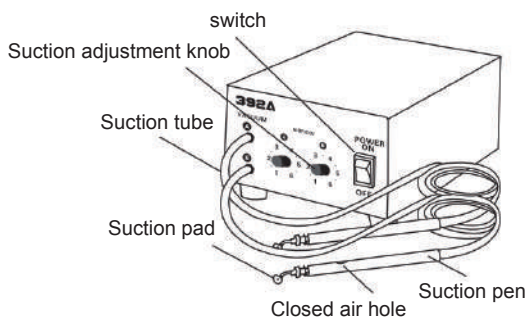
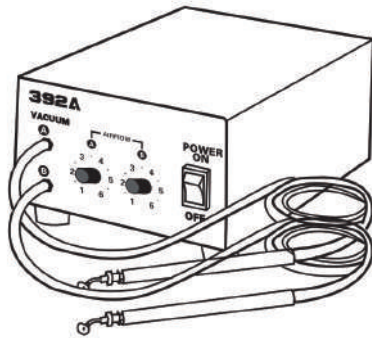

control panel

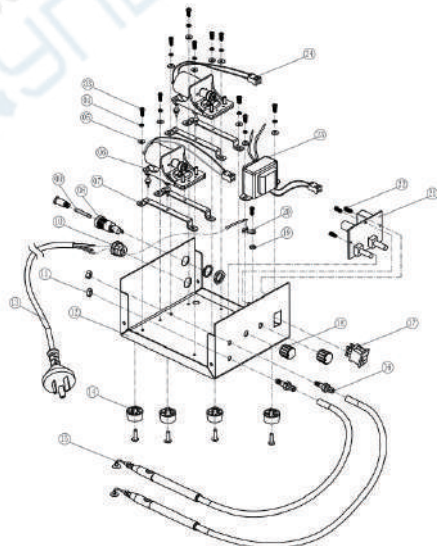
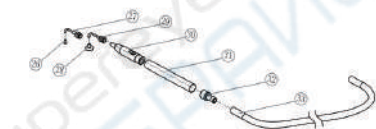
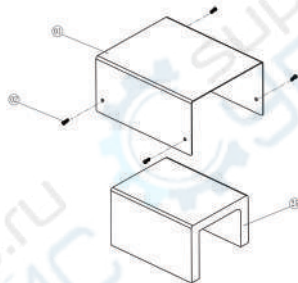

NO.	Parts Name	NO.	Parts Name
01	Upper Shell	18	rotary knob
02	cross screw	19	flower washer
03	cross screw	20	ground terminal
04	backup ring	21	PCB board
05	flat gasket	22	cross screw
06	Small air pump	23	transformer
07	Hardware tablet	24	plug
08	fuse holder	25	sound-absorbing cotton
09	fuse	26	Suction pad
10	wire clip	27	curve suction nozzle
11	nut	28	Suction pad
12	lower shell	29	curve suction nozzle
13	power supply cord with plug	30	handle set
14	foot pad	31	Stainless steel tube
15	handle	32	handle set
16	copper connection	33	Soft suction pipe
17	Switch with light		

### Features

- (1) Strong absorbing ability, low noise, continuous working time up to 1000 hours.
- (2) Applied to absorb flat circuit board, resistance and other small and round elements
- (3) Built-in Vacuum pump, no need connecting air system unnecessary
- (4) Strong suction, able to absorb up to 120g weight of the object
- (5) Static elimination design, vacuum pen, vacuum pad and leading tube are all made from static elimination material which is safer to sensitive elements

### Specifications

Power	5W
Pump	Diaphragm Model
Vacuum Pump Pressure(Max)	280mmHg
Size	Domination station: 136(W)X160(D)X83(H)mm
	Vacuum Pen: 123(L)X10mm(Outer Diameter)
	Tube: 1200(L)x6mm(Outer Diameter)
Weight	Domination station: 1.65kg
	Vacuum Pen: 25g
Curve Vacuum tip	Inside Diameter: 0.4mm/1.1mm
Vacuum Pad	Outer Diameter: 3mm/10mm
	Material: Conductive material silica gel

### Application of vacuum Pick-up Station

Vacuum tip/Pad	Max Item Weight	Application
Curve Vacuum tip(0.4mm)	1.2g	Flat small resistance and other small components
Curve Vacuum tip(1.1mm)	4g	Small IC(8-40pin)
Curve Vacuum tip(1.1mm)+Vacuum pad(3mm)	40g	IC above 40pin
Curve Vacuum tip(1.1mm)+Vacuum pad(7mm)	120g	The bigger electronic component

### Operating Instructions

1. Plug the power supply into a power outlet.
2. Turn on the power switch of the vacuum pick-up station, and it starts to work.
3. Hold the pick-up pen. When you want to pick up the object, press the air hole on the pen by hand. At this time, the vacuum tip of pen generates suction, that is, the object is sucked. If you want to loosen the object, loosen the air hole.
4. When sucking the chip resistor, capacitor and other small components, the vacuum tip can be used separately; when sucking a larger chip, the vacuum tip should be used with the corresponding suction pad.
5. The pick-up pen can be moved freely, and the finger is released at the determined position, and the object is placed.

### ! note :

When sucking a heavier object, it can be used with a suction pad. The suction pad can help to absorb the object more stably, and can also replace the suction pad of different sizes.