



**Trinocular, Inclination 30° & WF10x/22mm Eyepiece**

**Trinocular**

Correctly adjusting the interpupillary distance so that the distance of the eyepiece tube is correct with interpupillary distance, when observe through two-eyepieces, after the set pupal center distance of the eyepiece tubes by turning the left or right frame body



**Quintuple Nosepiece, Ball Bearing Inner Locating**

Quintuple Nosepiece, Ball Bearing Inner Locating  
LWD Infinity Bright Field Plan Objective (No Cover Glass)

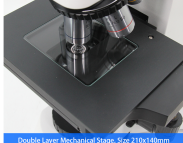

**Double Layer Mechanical Stage, Size 210x140mm**

**Working Stage**

Double Layer Mechanical Stage, Size 210x140mm, Moving Range: 60x60mm

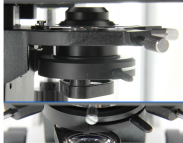

**Abbe Condenser N.A.=1.25, Rack & Pinion Up/Down Adjustable**

**Abbe Condenser**

N.A.=1.25, Rack & Pinion Up/Down Adjustable



Switch Eyepiece & Photo  
EYES/POLAR/PHOTO

Switch Reflect & Transmitt Illumination

Left Hand

Analyzer & Polarizer  
For Polarizing Observe

Right Hand



**Filters**

**Aperture Diaphragm**

**Field Diaphragm**



**Bright Field And Dark Field Switch**



**LWD Infinity Bright/Dark Field Plan Objective**



**A13.0211 Upright Metallurgical Microscope, Transmit & Reflect, BF/DF, DIC, Polarizing**

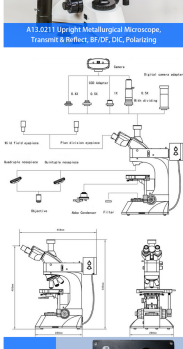

**5x/10x/20x DIC Push-Pull Group Slide**

	A13.0211 Upright Metallurgical Microscope, Transmit & Reflect, BF, DF, Polarizing	A13.0211	BF	DF	DIC	POLAR	Unit No.
Head	Trinocular inclination 30°, inclination 30° interpupillary 50-70mm, Left Side Eyepiece Tube/Right Adjustable Left Eyepiece Eyepiece/22mm	•	•	•	•		
Eyepiece	WF10x/22mm	••	••	••	••		104 0200-1002
Nosepiece	Quintuple ball bearing inner locating	•	•	•	•		104 0200-0100
Left Hand Bright Field Plan Objective (No Cover Glass)	PL10x/22mm, WFO 22mm	•					104 0200-1001
	PL20x/10mm, WFO 16mm	•					104 0200-1002
	PL40x/10mm, WFO 10mm	•					104 0200-1003
	PL100x/10mm, WFO 6.5mm	•					104 0200-1004
Left Hand Bright/Dark Field Plan Objective (No Cover Glass)	PL10x/22mm, WFO 22mm, Spring	•	•				104 0200-1005
	PL20x/10mm, WFO 16mm, Spring	•	•				104 0200-1006
	PL40x/10mm, WFO 10mm, Spring	•	•				104 0200-1007
	PL100x/10mm, WFO 6.5mm, Spring	•	•				104 0200-1008
Left Hand DIC Plan Objective (No Cover Glass)	DL10x/22mm, WFO 22mm	•					104 0200-1009
	DL20x/10mm, WFO 16mm	•					104 0200-1010
	DL40x/10mm, WFO 10mm, Spring	•					104 0200-1011
	DL100x/10mm, WFO 6.5mm, Spring	•					104 0200-1012
Left Hand OC Plan Objective (No Cover Glass)	LW10x/22mm, WFO 22mm	•					104 0200-1013
	LW20x/10mm, WFO 16mm	•					104 0200-1014
	LW40x/10mm, WFO 10mm	•					104 0200-1015
Left Hand OC Bright/Dark Field Plan Objective	DL10x/22mm, WFO 22mm	•					104 0200-1016
	DL20x/10mm, WFO 16mm	•					104 0200-1017
Working Stage	Double Layer Mechanical Stage, Size 210x140mm, Moving Range: 60x60mm	•	•	•	•		
Condenser	Abbe Condenser N.A.=1.25, Rack & Pinion Up/Down Adjustable	•	•	•	•		
Control Panel	Switch Eyepiece & Photo, Switch Reflect & Transmitt Illumination, Analyzer & Polarizer For Polarizing Observe	•	•	•	•		
Filter	5x/10x/20x DIC Push-Pull Group Slide	•	•	•	•		
Aperture Diaphragm	Aperture Diaphragm	•	•	•	•		
Field Diaphragm	Field Diaphragm	•	•	•	•		
Bright Field And Dark Field Switch	Bright Field And Dark Field Switch	•	•	•	•		
Objective Lenses	LWD Infinity Bright/Dark Field Plan Objective	•	•	•	•		
Microscope	A13.0211 Upright Metallurgical Microscope, Transmit & Reflect, BF/DF, DIC, Polarizing	•	•	•	•		